

THE OPEN

Royal Liverpool 2014



Who helps you get more from your game?

With HSBC Premier, you will enjoy free membership to our HSBC Premier Golf Network. This exclusive service provides players of all abilities with preferential access to some of the best courses in Britain.

Our fantastic green fees and bespoke lesson packages with PGA Pros will help you get the most out of this great game.

Monthly instructional videos and magazine articles support great money-can't-buy competitions and offers that are exclusive to HSBC Premier Customers.

HSBC Premier eligibility criteria applies.

To discover more about HSBC Premier, visit hsbc.co.uk/premier or your local branch.

Or call us on 0800 432 0576.

To find out about our Premier Golf Network, visit www.hsbc.co.uk/premier-golf-network.



HSBC 
Premier

Issued by HSBC Holdings plc. HSBC Premier is subject to status, account opening criteria and local regulatory requirements. Textphone 1800 108457 125 563. Lines are open 24 hours. Communications may be recorded and monitored for security and service improvement purposes.
AC17891



Ticket Information

R&A



JUNIORS

Children under 16 years of age on 12 July 2014 with pre-booked Junior tickets or accompanied by a responsible adult who holds a valid course admission ticket will be admitted free of charge on all Practice and Championship days. See the centre pages for further details.

MOBILE DEVICE APPS

A complimentary Wi-Fi network, providing access to The Open App, will be available, enabling spectators to keep up-to-date with all the action around the course. A host of official iPad, iPhone, Android, BlackBerry and Windows 8 mobile Apps can be downloaded in June via Apps.TheOpen.com.

PRACTICE DAYS

For details of Practice day prices, when an Adult ticket can be purchased for as little as £10.00, please see the table in the centre pages.

GRANDSTANDS

Approximately 20,000 Public seats will be located around the course and at the Practice Ground and will be free of charge to all spectators. A limited number of reserved grandstand seats at the 18th Green can be purchased in advance.

THE OPEN SHOP

This will feature the exclusively designed and produced Open Collection for men, women and children including apparel, headwear, outerwear and golf accessories. Ralph Lauren, Official Outfitter to The Open Championship, will also present their RLX Golf, Polo Golf and Ralph Lauren Golf ranges. Free bag drop, personalisation station, onward shipping and VAT refund facilities will be available.



PLEASE SILENCE YOUR MOBILE DEVICE

Mobile phones can distract players. Use of Mobile Devices must be confined to the Mobile Device Zones.

NO PHOTOGRAPHY

NO Video recording allowed at any time.
NO Photography on Championship days.





TRAVEL BY ROAD

It is anticipated that, given the high number of spectators likely to attend The Open Championship, the surrounding road network will be busy. The Police are urging all motorists to use the designated traffic routes, which will be clearly signed by the AA. Visitors and spectators are advised to turn off their satellite navigation systems and follow the appropriate signage. Visitors travelling from the North should exit the M6 at junction 20A and join the M56 signed for Chester. Leave the M56 at junction 15 and join the M53 heading towards Birkenhead, Wirral. Visitors travelling from the East (Manchester) should exit the M62 at junction 10 and join the M6 Southbound. Thereafter, exit the M6 at junction 20A and join the M56

signed for Chester. Leave the M56 at junction 15 and join the M53 heading towards Birkenhead, Wirral. Visitors travelling from the South should exit the M6 at junction 20A and join the M56 signed for Chester. Leave the M56 at junction 15 and join the M53 heading towards Birkenhead, Wirral. Visitors travelling from North Wales on the A55 should follow the signs for the M53 at junction 12 heading in the Ellesmere Port direction. Please follow AA signage from the M53 to the Park and Ride, Reserved Label car parks and Coach Parking. Those ignoring the identified routes are likely to experience lengthy delays.



PARK AND RIDE

Designated routes will lead to Park and Ride facilities operating

from all Public car parks. These facilities will reduce delays, allowing motorists to travel to and from the course on the dedicated buses provided. Spectators are strongly encouraged to use the Park and Ride facilities to minimise disruption to local traffic and ensure a swift transfer to The Open Championship.



PARKING CHARGES

Weekly Car Park labels are available at a cost of £60.00. Weekly labels are only available in advance from The R&A and are subject to availability. Daily Public car parking, payable in advance or on arrival, will cost £10.00 from Sunday 13 to Tuesday 15 July and £15.00 from Wednesday 16 to Sunday 20 July. Park and Ride operating times will be

displayed on TheOpen.com. Daily Coach Parking is free but will be on a first come, first served basis.



SPECTATORS WITH DISABILITIES

Spectators with mobility impairments who intend to purchase tickets in advance or on the day at the gates are advised to telephone The R&A Ticket Office (01334 460000) for details on access and car parking arrangements.



TRAVEL BY RAIL

Merseyrail provides a convenient and easy way to travel to The Open. Passengers travelling via Lime Street Station, Liverpool, should change onto the Merseyrail Wirral Line for trains to Hoylake. Visitors are asked to disembark the train at Hoylake Station and then take a short 5 minute walk to the course. An enhanced service will run during the Championship. For more information on public transport in Merseyside, call Traveline on 0870 608 2608, or log onto merseytravel.gov.uk.

TRAVEL BY AIR

Royal Liverpool Golf Club is served by Liverpool John Lennon Airport (20 miles) and Manchester Airport (46 miles). Details regarding Helipad operations will appear on TheOpen.com

TRAVEL BY BICYCLE

Cycle Parks will be located within specific car parks close to the course. Details of these will appear on TheOpen.com.

Traffic reports will be broadcast on local and national radio and full details of frequencies will be indicated on the designated routes. Further information relating to routes will be published on TheOpen.com

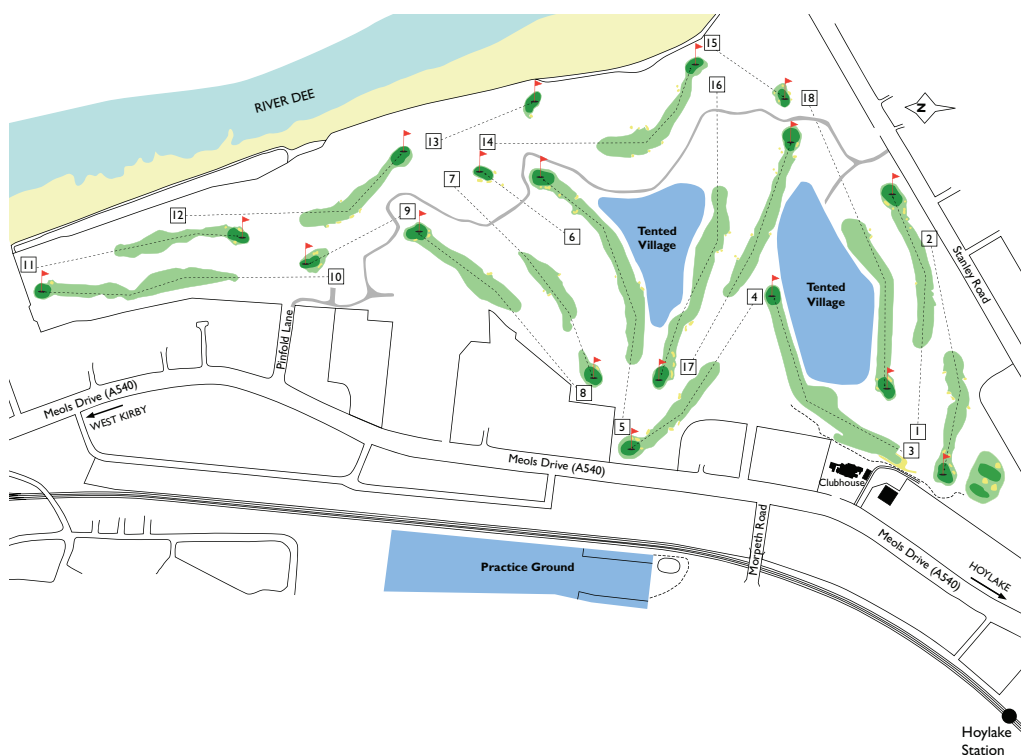



THE OPEN CHAMPIONSHIP
ROYAL LIVERPOOL
16-20 JULY 2014

TheOpen.com/hospitality



THE OPEN
.com

Take advantage of early season prices and avoid queues at the paygates by purchasing your tickets before the end of May. Tickets will also be available for purchase on arrival at the course.

Name: _____ (BLOCK CAPITALS PLEASE)

Company (if applicable):

Address:

Postcode:

Daytime Telephone No:

Email Address:

[illegible]

Please complete the details below or telephone the Ticket Office on **01334 460010** or go to **TheOpen.com**

Please debit my MasterCard	Visa	Maestro
-----------------------------------	-------------	----------------

Card No.

Expiry Date Maestro Issue Number

Name and initials on Card:.....

Authorised Signature:

Please make all cheques and postal orders payable to
“R&A Championships Limited”

I enclose a cheque for TOTAL £

Please tick if you do not wish to receive further information from The R&A.

THE OPEN
HOSPITALITY

* See notes opposite		Before 31 May 2014			From 1 June 2014		
		Price	No.	Value	Price	No.	Value
Season Tickets (Sun 13 – Sun 20 July)							
Admission to course for week		£220			£240		
Daily Tickets – Adults							
Practice Days	Sunday 13 July	£10			£15		
	Monday 14 July	£20			£25		
	Tuesday 15 July	£25			£30		
	Wednesday 16 July	£30			£40		
Championship Days	Thursday 17 July	£65			£75		
	Friday 18 July	£65			£75		
	Saturday 19 July	£65			£75		
	Sunday 20 July	£65			£75		
Daily Tickets – Concessions (16-21 years)*							
Practice Days	Sunday 13 July	£5			£5		
	Monday 14 July	£10			£15		
	Tuesday 15 July	£10			£15		
	Wednesday 16 July	£15			£20		
Championship Days	Thursday 17 July	£25			£30		
	Friday 18 July	£25			£30		
	Saturday 19 July	£25			£30		
	Sunday 20 July	£25			£30		
Daily Tickets – Juniors (under 16 years) Free of charge.*							
18th Green Reserved Grandstand* (Does not include course access)							
Weekly		£250			£250		
Daily							
Championship Days	Thursday 17 July	£50			£50		
	Friday 18 July	£75			£75		
	Saturday 19 July	£75			£75		
	Sunday 20 July	£100			£100		
Fairways Club* (Does not include course access)							
Practice Day	Wednesday 16 July	£30			£30		
Championship Days	Thursday 17 July	£50			£50		
	Friday 18 July	£50			£50		
	Saturday 19 July	£50			£50		
	Sunday 20 July	£50			£50		
Car Parking – Weekly Only available in advance		£60			£60		
Car Parking – Daily (Park & Ride) Can be purchased in advance or on the day							
Practice Days	Sunday 13 July	£10			£10		
	Monday 14 July	£10			£10		
	Tuesday 15 July	£10			£10		
	Wednesday 16 July	£15			£15		
Championship Days	Thursday 17 July	£15			£15		
	Friday 18 July	£15			£15		
	Saturday 19 July	£15			£15		
	Sunday 20 July	£15			£15		

Please note that owing to the limited number of Greenside Club, Reserved Grandstand Seats and Fairways Club tickets available, a maximum of four per application is permitted. Please advise if you wish your name to be placed on a waiting list for cancellations.

Tickets can be ordered by completing this form. Detach the centre pages and return to The R&A Ticket Office.

Greenside Club (see below)	Including Car Park			Excluding Car Park		
	Price	No.	Value	Price	No.	Value
Weekly	£660			£600		
Daily						
Championship Days	Thursday 17 July	£215		£200		
	Friday 18 July	£240		£225		
	Saturday 19 July	£240		£225		
	Sunday 20 July	£265		£250		
Greenside Club, Reserved Grandstand, Fairways Club and Weekly Car Parking are subject to availability	TOTAL					
	£			£		

- Greenside Club**
- A Greenside Club ticket includes the following:
- Access to the Course
 - A reserved seat in an exclusive stand at the 18th Green
 - Access to the Greenside Club Marquee (exclusive lounge with bar and dining services. Complimentary tea, coffee and newspapers)
 - Access to The Links Pavilion (relaxed restaurant, lounge and bar)
 - A copy of the Official Programme
 - An Information Guide (drawsheet) per day
 - A Car Park Label (optional)

18th Green Reserved Grandstand

This badge must be used in conjunction with a ticket permitting course access. There will also be Public grandstand seats throughout the course which are free of charge. These are all available daily on a first come, first served basis.

Fairways Club

Access to a private marquee, the Fairways Club offers a lounge, bar and snack facility, with complimentary tea and coffee. You may wish to purchase food and drink from our great range of offers on sale. This badge must be used in conjunction with a ticket permitting course access.

Concessions (16-21 years)

Spectators aged 21 years or under on 12 July 2014 will be entitled to purchase Concessions (16-21 years) tickets.

- Junior Tickets Terms and Conditions (Kids Go Free)**
1. Children under 16 years of age on 12 July 2014 are eligible for free Junior tickets. These are available on a pre-booked basis or at the paygate in accordance with the following:
 2. Applications for pre-booked Junior tickets must be submitted prior to the Championship (before 27 June 2014) by applying in writing to: Ticket Office, The R&A, St Andrews, Fife, KY16 9JD. The application should be accompanied by a suitable form of age identification (e.g. letter from school or golf club) for each child applying for a Junior ticket. Please state which day(s) you wish to attend and the number of tickets required.

Sun 13	Mon 14	Tue 15	Wed 16	Thu 17	Fri 18	Sat 19	Sun 20
--------	--------	--------	--------	--------	--------	--------	--------

3. A child who arrives at the paygate without a pre-booked Junior ticket, but who is accompanied by a responsible adult who holds a valid course admission ticket (Adult or Concessions (16-21 years)), will be admitted free of charge on the day and will be given the appropriate ticket at the paygate.
4. A child who arrives at the paygate without a pre-booked Junior ticket and who is not accompanied by a responsible adult who holds a valid course admission ticket (Adult or Concessions (16-21 years)) will not be entitled to a Junior ticket but will be entitled to purchase a Concessions (16-21 years) admission ticket.
5. Where you are the responsible adult accompanying a child for the purposes of that child obtaining a "Kids Go Free" Junior ticket at the paygate, you are responsible for the supervision of that child during the event.

STAY ON THE BALL



The world's oldest championship meets the world's newest technology at The Open. In a ground breaking innovation for golf, Wi-Fi is available across the golf course, giving you access to TV coverage and live scoring on The Open App through your own smartphone or tablet.

WHERE TECHNOLOGY
MEETS TRADITION



THE OPEN
CHAMPIONSHIP



Spectator Information

THE OPEN
.com



MOBILE DEVICE & CAMERA POLICY

A strict policy will be in place to ensure play is not disrupted in any way.

- All devices must be in SILENT mode at all times.
- Calls must be placed or received in approved designated areas, referred to as "Mobile Device Zones".
- No audio or video capture is permitted at any time.
- No still photography is permitted on Championship Days.
- Data use (e.g. texting, e-mail, website access, etc) is permitted throughout the golf course. Volume must be muted at all times.

Spectators who breach any provision of this policy will be subject to the terms and conditions of ticket sales.



FACILITIES FOR SPECTATORS WITH DISABILITIES

Viewing areas have been set aside at a number of greens for those in wheelchairs. For further information on viewing areas, car parking and all other matters, please go to TheOpen.com or contact The R&A Ticket Office (01334 460000).

SAFETY

Please be reminded that under wet conditions the ground may become slippery and appropriate footwear should be worn. Observe the instructions of marshals at all times when on-course and on grandstands.

Visit the 2014 Open Shop

Take home more
than just a memory.

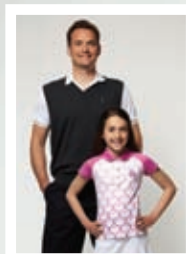

The Open Collection
OFFICIAL MERCHANDISE

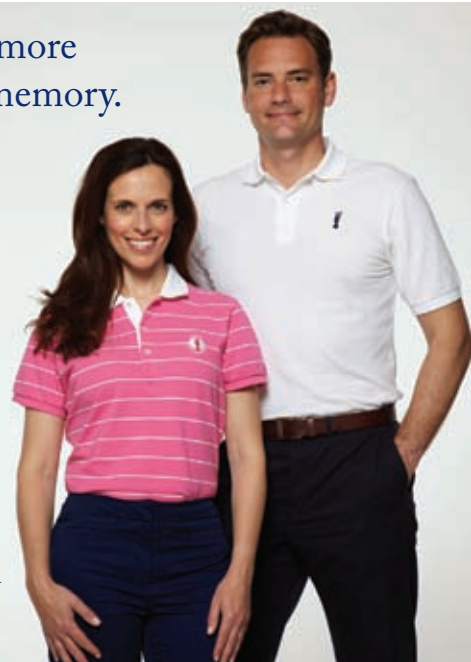

NO STEP LADDERS



NO PETS

BANKING SERVICE



HSBC is one of the world's largest banking and financial services organisations. As a Patron of The Open Championship, HSBC will provide a full service HSBC branch in the Tented Village enabling spectators to access money, free of charge, from several ATMs. Additionally, Personal Advisers will be on hand to discuss any business, personal and foreign exchange requirements. HSBC Premier customers can enjoy complimentary refreshments in the HSBC Premier lounge located within the branch. Opening hours are 8.00 a.m. - 6.00 p.m. Sunday 13 - Sunday 20 July.



LEFT LUGGAGE FACILITIES

There will be several complimentary left luggage facilities located throughout the Tented Village, operated on a first come, first served basis. Please note that security bag searches may be in operation.



CATERING FACILITIES

There are many licensed catering points both on course and within the Tented Village.

OFFICIAL PROGRAMMES

Programmes may be purchased from kiosks at The Open. In addition, they will be available by post from Friday 11 July 2014. Phone Freephone number 0808 100 7377 with your credit or debit card details. Alternatively, you can order on the internet from TheOpen.com or thepplgroup.com

LARGE SCREENS

Keep up-to-date with the action on the large screens located at selected greens and in the Tented Village.

BINOCULARS

Nikon is a Patron of The Open Championship and a full range of binoculars is available for sale or hire from the Nikon Marquee in the Tented Village.



ACCOMMODATION

For information regarding hotel and bed & breakfast accommodation, plus information for those seeking private accommodation by way of renting houses, please go to TheOpen.com/accommodation or email enquiries@StayatTheOpen.com

HSBC GOLF ZONE

Back for the fourth time is the hugely popular HSBC Golf Zone which gives all spectators the opportunity to test out their golf skills and the chance to win a host of daily prizes. The HSBC Golf Zone is free of charge and welcomes all spectators.

THE R&A SWINGZONE

Free golf lessons are available all week from PGA professionals in The R&A Swingzone.

AUTOGRAPHS

To assist players and spectators, a specific autograph area will be designated and signposted at The Open.

MASTERCARD

In the run-up to the Championship, there will be chances to win Priceless experiences, privileged access and unique offers courtesy of MasterCard. To find out more go to TheOpen.com/mastercard and be sure to visit the MasterCard Club in the Tented Village.

THE SENIOR OPEN 2014

The Senior Open Championship Presented by Rolex will be held at Royal Porthcawl, Wales, from Thursday 24 to Sunday 27 July 2014. Spectators who hold a valid admission ticket from the previous week's Open Championship at Royal Liverpool will be entitled to purchase a half price Senior Open admission ticket at the paygates. For further information, please contact the European Tour Ticket Office on telephone number 0800 023 2557 or go to senioropengolf.com

2015 VENUE

The 2015 Open Championship will be held at St Andrews from 12 – 19 July.

Format for the Championship

156 competitors will play 36 holes of stroke play on Thursday 17 and Friday 18 July. The leading 70 players and ties will play a further 36 holes on Saturday 19 and Sunday 20 July. The Champion will be the player with the lowest 72 hole aggregate. In the event of a tie, the players will play a four hole play-off. The Champion will be the player with the lowest four hole aggregate. If there is still a tie, play will continue over the 18th until a winner emerges. The presentation ceremony will be held immediately after the conclusion of play.



GATE OPENING TIMES

Approximate daily opening times:

Sunday 13 July	9.00 a.m.
Monday 14 July	7.00 a.m.
Tuesday 15 July.....	7.00 a.m.
Wednesday 16 July.....	7.00 a.m.
Thursday 17 July.....	6.00 a.m.
Friday 18 July.....	6.00 a.m.
Saturday 19 July.....	7.00 a.m.
Sunday 20 July	7.00 a.m.

HOURS OF PLAY

Daily tee times are as follows:

(*denotes approximate times)

Sunday 13 to Wednesday 16 July
Players practising throughout the day. Information will be available on TheOpen.com and will be displayed on Practice Starting Times boards.

Thursday 17 July

First: 6.30 a.m. Last: 4.21 p.m.

Friday 18 July

First: 6.30 a.m. Last: 4.21 p.m.

Saturday 19 July

First: 9.00 a.m.* Last: 3.00 p.m.

Sunday 20 July

First: 8.30 a.m.* Last: 2.30 p.m.

